



# Great Kit for your great business, **Emkit**

Throughout the enterprise device's lifecycle, EmKit will be with you to increase your business outcome and improve productivity.

You can meet easy development, simplified management, efficient work routine with EmKit.

# Index

01

---

## Development

- Optimized Software Development

02

---

## Management

- Handy Provisioning for Fast Deployment
- Prevent Distractions, Kiosk Mode
- Management After Deployment

03

---

## Productivity

- Monitor the Device Health
- Customize device to suit your work
- Take Full Advantage of Data Scanning
- Multiple Wedge Profiles, Multiple Apps

# Development

---

Develop faster and less costly with SDK and development kit.

# Optimized Software Development

# Development



Unified SDK  
for Android



RFID  
Development Kit

## Unified SDK for Android & RFID Development Kit

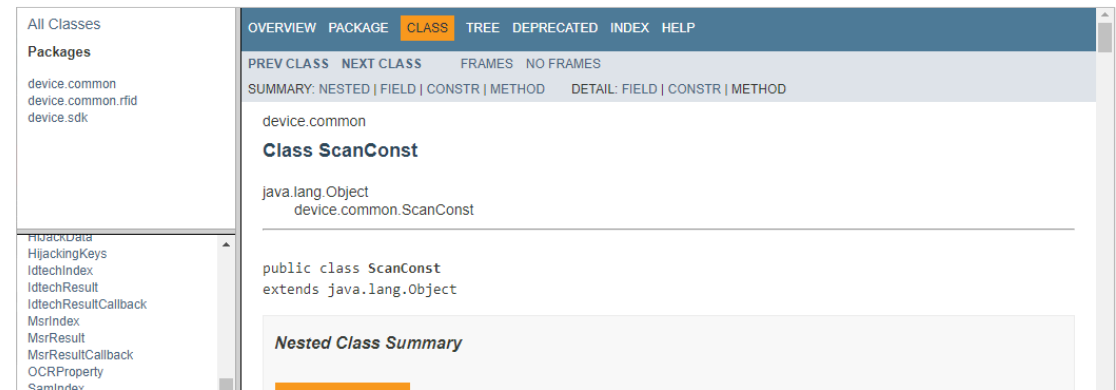
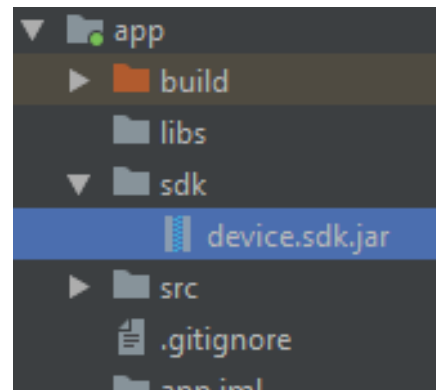

Unified SDK includes:

- APIs that control the scanner, SAM, MSR modules, etc.
- Google Generic SDK
- API documentation

Develop the enterprise functions faster and less costly with Development tools provided by **EmKit**.

# Management

---

Provision and manage devices efficiently.



# Prevent Distractions: Kiosk Mode



## Power Launcher

Implement basic kiosk mode with **Power Launcher** (Android 8 and below only).

- Restricts some system features
- Locks the users into the home screen the accessible apps are placed

# Manage- ment

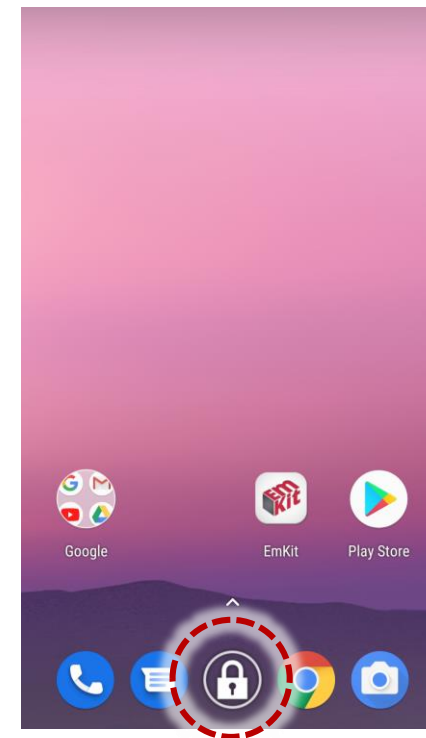
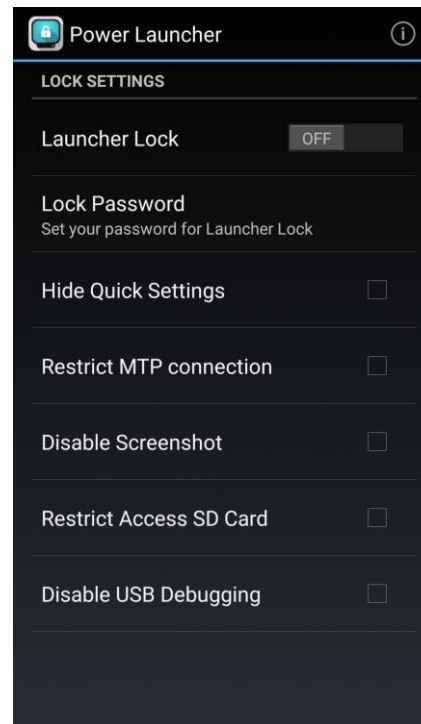

# Prevent Distractions: Kiosk Mode



EmKiosk

## EmKiosk & EmKioskConfig

More expanded and flexible kiosk mode. In addition to the Power Launcher's features, EmKiosk can

- Selects accessible apps
- Allows or blocks system settings & features (screenshot, MTP connection, etc.)
- Screen lock



EmKioskConfig

EmKiosk can be configured by PMDM/Scan2Stage (PC Tool) or **EmKioskConfig** (Android app).

**EmKioskConfig** provides intuitive UI and it helps you make all **EmKiosk** configurations easily using a single device. And the configuration can be deployed to nearby devices fast using **Direct Clone**.

# Manage- ment

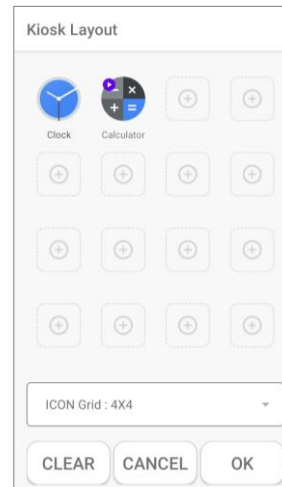

EmKioskConfig

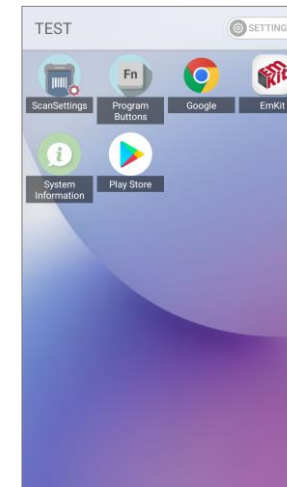

EmKiosk

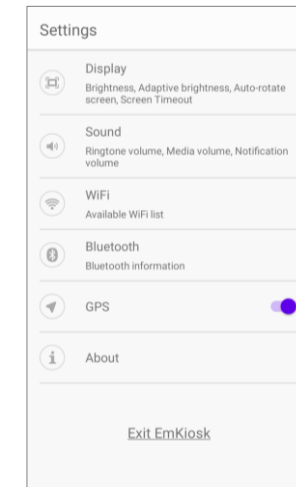

# Handy Provisioning for Fast Deployment

**Develop Provisioning Solutions  
for Customer Satisfaction**

**Manage-  
ment**

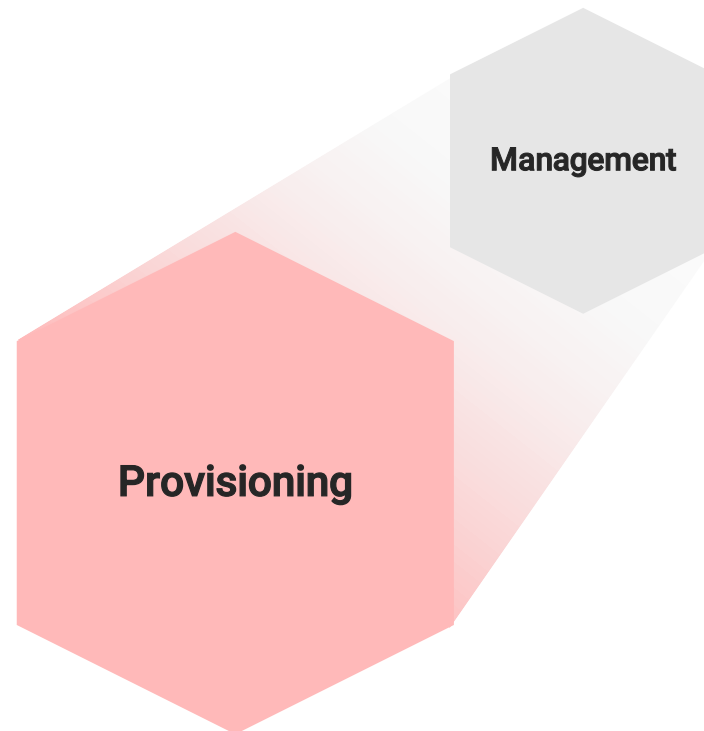

Provisioning is an essential step for enterprise devices.

Point Mobile has developed provisioning solutions for easier & faster process.

During this development, we always listen to VoC (Voice of Customer).



# Handy Provisioning for Fast Deployment



Direct Clone

## Direct Clone

Direct Clone is a powerful way to provision devices in close range **without an internet connection**.

1. Configure the desired settings on a master device.
2. Make a backup file.
3. Run **Direct Clone hotspot** to make the device act as a local server.  
The server transfers the backup file to nearby client devices and they restore automatically.

# Management

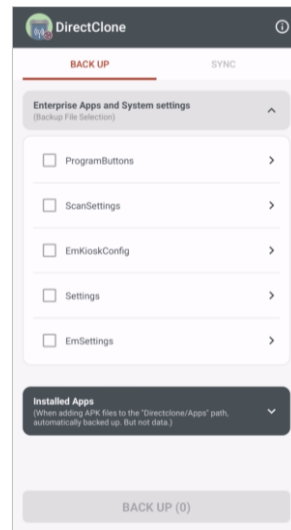

Master Device

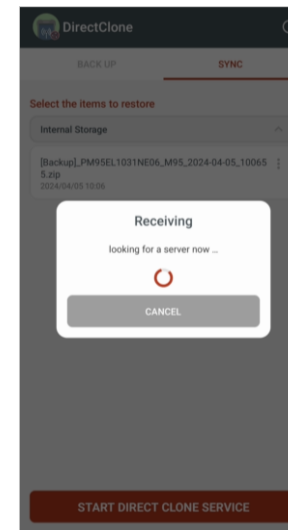
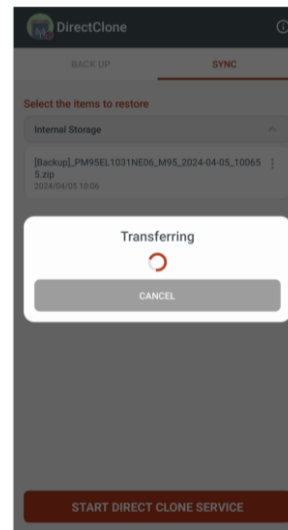

Client Devices

### Restriction of Direct Clone

- Same Place
- Same OS & Same PN

# Handy Provisioning for Fast Deployment



Scan2Stage

## Scan2Stage & Scan2Set

Removed Direct Clone restrictions and expanded the configuration coverage.

Using **Scan2Stage**, you can easily configure the device settings and generate secured QR code with no programming knowledge.

Your devices will complete the provisioning process automatically by simply scanning the QR code with **Scan2Set**.



Scan2Set

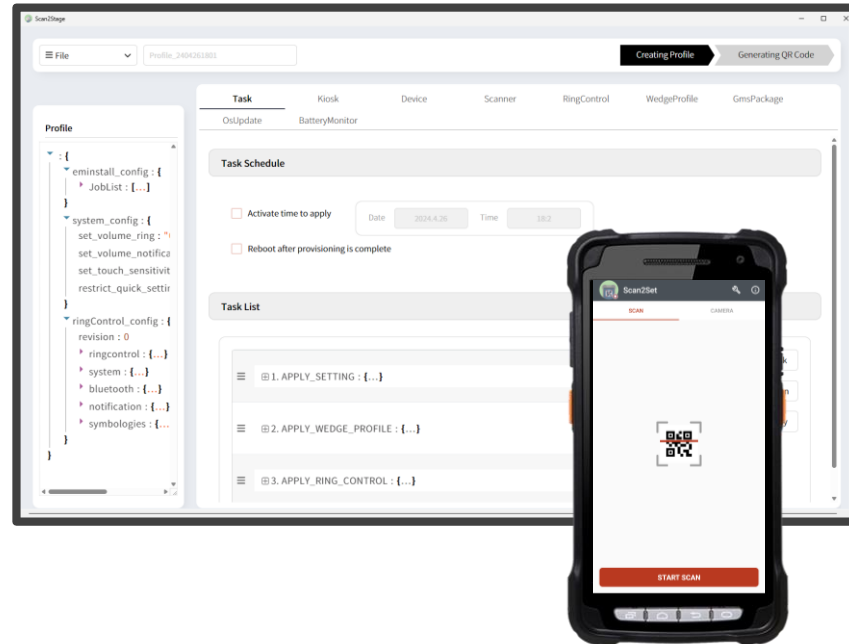

### Profile Configurations

- Device and scanner settings
- Enable or disable GMS packages
- Perform OS update
- Install & launch applications
- Restrict system features
- Define keypress behavior
- Configure EmSolutions (EmKiosk, WedgeProfiler, etc.)

# Management

# Management after Deployment



## PMDM

Experience efficient management of the deployed devices.

The enrolled devices are synced through **PMDM** server and ready to receive a message from the administrator.

**PMDM** provides visibility of the device health so that you can foresight the replace time and prevent interruption.

# Management

### Major Features of PMDM

- **Easy Enrollment**
  - Enroll devices easily using a QR code
- **Monitoring the devices**
  - Provides visibility of the device statistics
- **Smart Group**
  - Connects assets (devices, profiles, files) by working area or type, etc.
- **Sending and Applying profile**
  - Provides full management features (implement configuration, OS update, etc.)
- **Remote Control**
  - Controls the device remotely

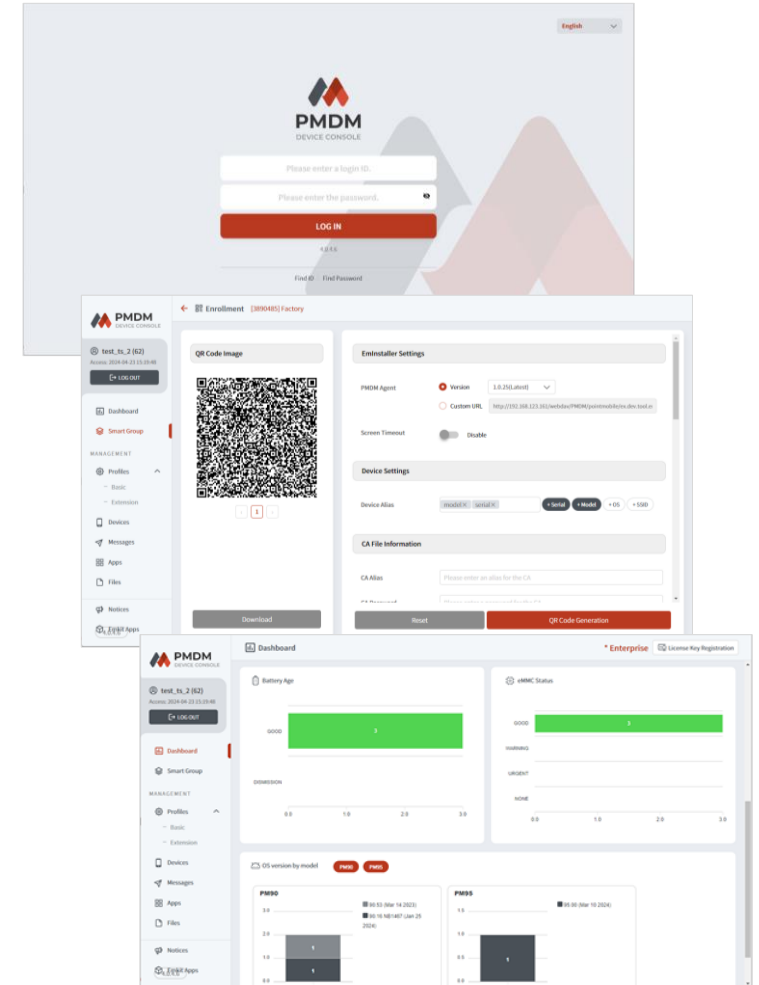

# Provisioning Solutions

## Management

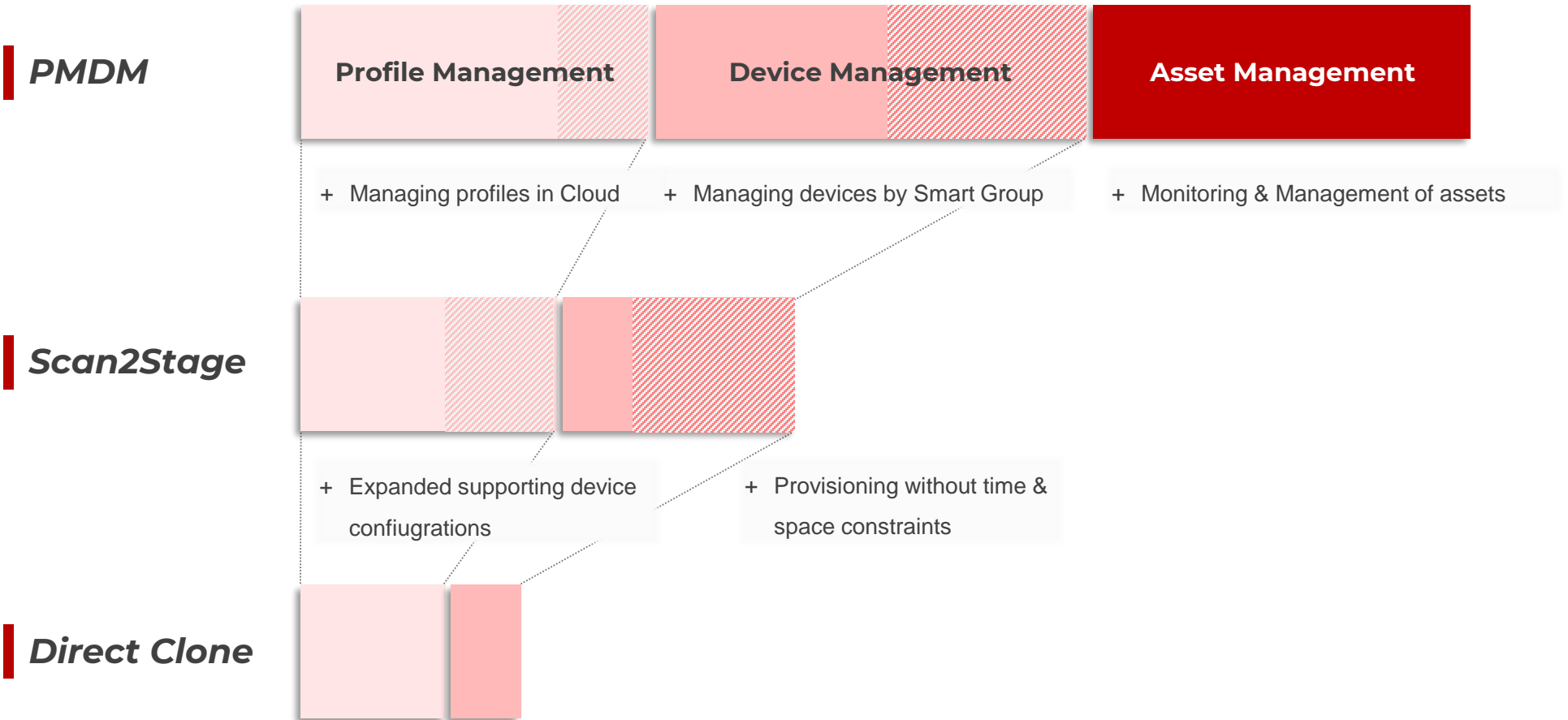

# Management after Deployment



PULS

## Manage Device Lifetime: PULS

Keep the devices up-to-date and secured for 7 years after product launching.

PULS provides new OS and security patches through FOTA (Firmware Over The Air).

So you can download from anywhere if you can connect to the network.

### Services

1. Security Patches
2. System Update and Upgrade



EmLogTool /LogTrace

## Integrated Logging Solution: EmLogTool, LogTrace

Take the log to analyze the issue you have.

EmLogTool/LogTrace provides centralized control of taking various types of log.

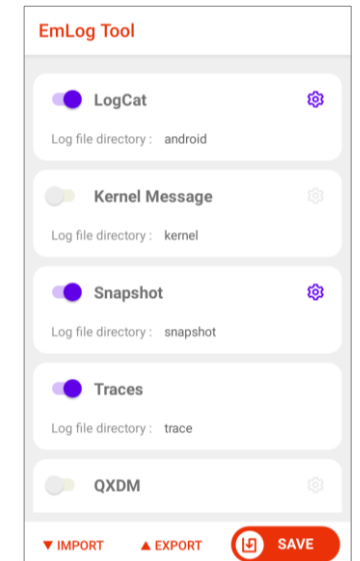
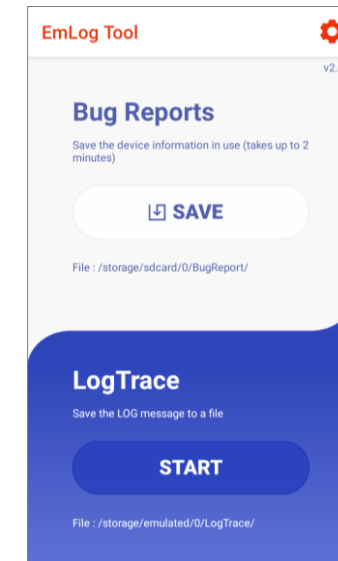

# Manage-

# ment

# Management after Deployment



Device Tracker

## Device Tracker

You can find a device lost or not in the proper location.

Device Tracker will list up the beacon signal embedded on the devices.

Select one signal and track the device following a beep sound indicating the distance.

# Management

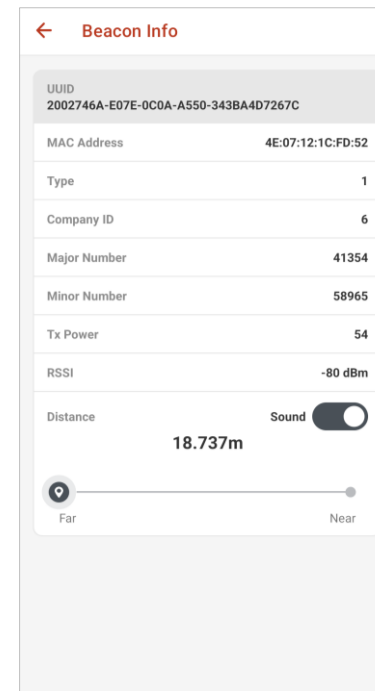

❖ Check if your device supports beacon-related features.

# Productivity

---

Recognize Device status and optimize devices for your work to increase productivity.

---

# Monitor the Device Health



EmHealthReport

## EmHealthReport

Keep monitor the device status to predict when the device need to check. Then the device downtime can be minimized.

**EmHealthReport** provides intuitive information of battery and eMMC to help you easily identify the device health and when they need to be charged or replaced.

# Productivity

**Battery Health**

Battery Age <span style="color: green;">✔</span> Good	Battery Level 51%
Battery First Use Date Optimizing	Battery Voltage 3.796 V
Battery Temperature 28.3 C	System Temperature 26.5 C
Battery Manufacture Date 28th week of 21'	Smart Charging Normal mode

Battery S/N B2105101000U7-2128

**eMMC Health**

Pre-EOL Information  
✔ Normal

Device life time estimation type A  
 0% - 10% of device life used

Device life time estimation type B  
 0% - 10% of device life used

**Battery Health**

- Battery Age
- Battery Level / Voltage
- Battery / System Temperature
- Battery Manufacture Date
- Battery Serial Number
- Battery First Use Date
- Smart Charging

**eMMC Health**

- Pre-EOL Information
- Device life time estimation type A/B



# Monitor the Device Health



## EmBatteryMonitor

EmBatteryMonitor informs the device user that the battery needs actions.

- Bad battery lifespan
- Battery overheat

The users can take action immediately or report to admin quickly based on the app's notification.

# Productivity

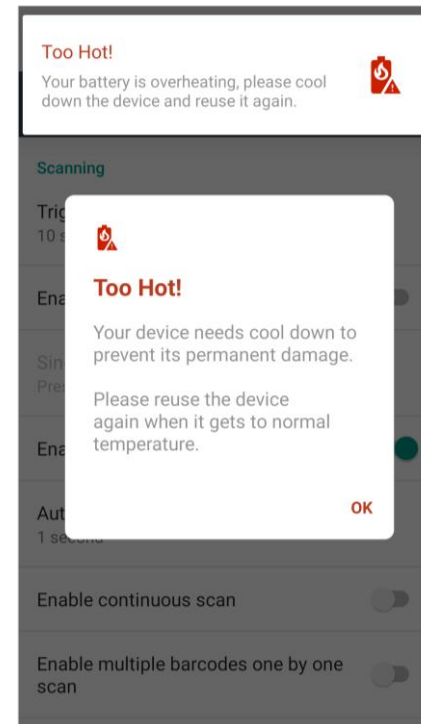
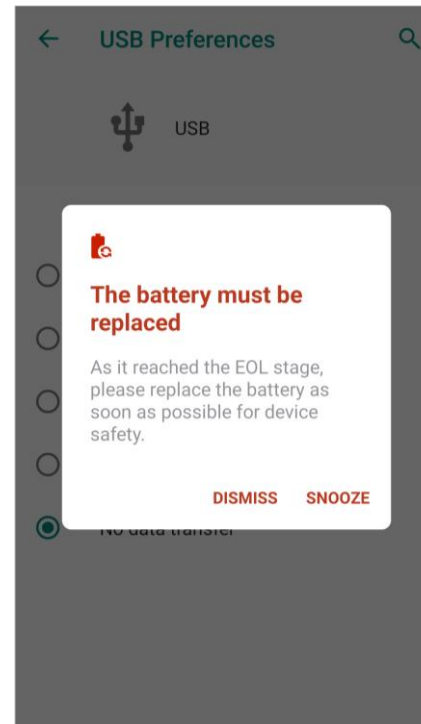

# Customize Device to suit your Work



## EmSettings

EmSettings contains various Point Mobile exclusive settings related to the Battery, Keypad, or Beacon, etc. Increase your productivity with the enterprise-optimized features.

# Productivity

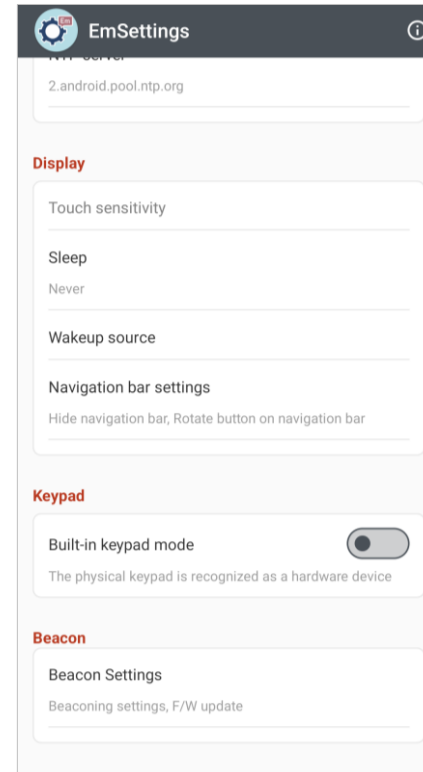
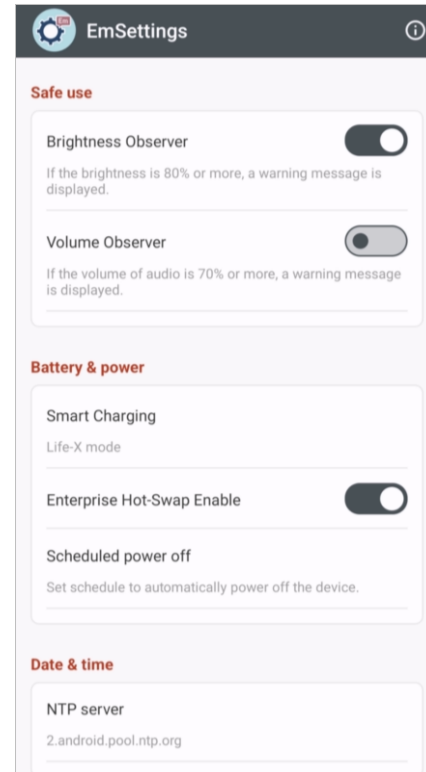

### Supported Settings

- Brightness & Volume Observer
- Scheduled Power Off
- Smart Charging
- Navigation bar settings
- Keypad settings
- Beacon settings

# Customize Device to suit your Work



Program Buttons

## Mapping HW Buttons: Program Buttons

Program Buttons provides button-related features such as key mapping with rich pre-assigned functions, preventing mispressing the power button, and applying KCM file.

Tip) SMART REMAP feature helps you find the button you want easily just by pressing the button.

On PM351 & PM451, you can also customize the symbol grid of the symbol button.

**Productivity**

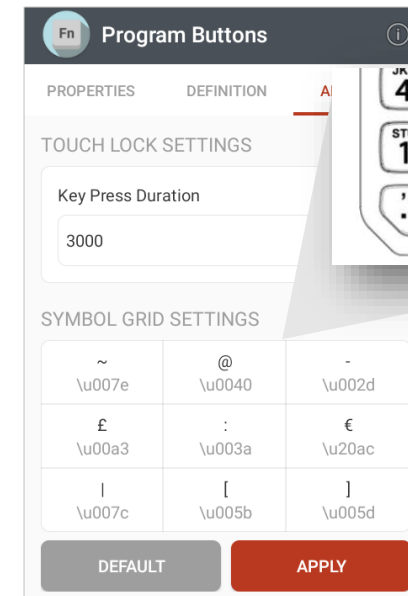
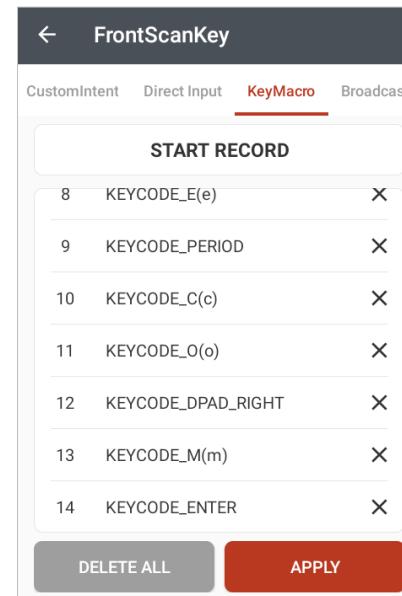
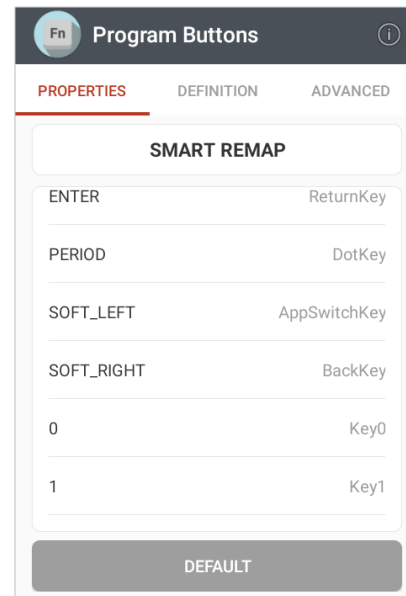

# Customize Device to suit your Work



Touch Sensitivity

## Even in Rain or Wearing Gloves: Touch Sensitivity

Ability to adjust the touch sensitivity level. Just choose one by your work environment.

- Work with wearing gloves -> Glove touch (Increase sensitivity for smooth touch action)
- Work in high humidity -> Wet touch (Decrease sensitivity for preventing unintended touch)

# Productivity

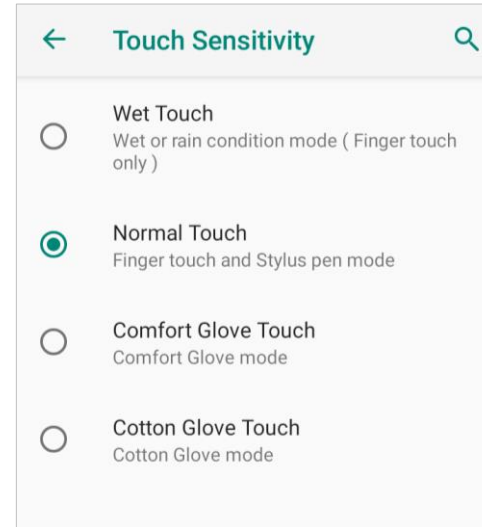

❖ The touch sensitivity options depends on the model.

# Take Full Advantage of Data Scanning

**Productivity**



ScanSettings

## ScanSettings

Manage the settings about scanner in **ScanSettings**.

You can enable/disable the features such as illumination, auto scanning, symbologies, etc. and also can set following features.



TouchScan

## TouchScan

Place the virtual scan button on the screen and tap the button to read a barcode instead of the hardware button. The virtual button provides flexibility of capturing action.



MultiScan

## MultiScan

Regardless 1D or 2D, you can scan multiple barcodes with a single triggering. With **MultiScan**, you can improve efficiency by eliminating time-intensive process of scanning each one individually.



PEW

## PEW (Powerful Extended Wedge)

Customize the barcode data style to be transmitted. Meet flexible data requirements such as changing a specific part of data or adding some string.

# Multiple Wedge Profiles, Multiple Apps



## WedgeProfiler

In the use case of using multiple work apps on a single device, each app can take its own data capture rule using **WedgeProfiler**.

While an app is running, the system delivers the scanned data using the wedge profile associated with the app instead of the global settings.

### Major Strength of WedgeProfiler

- Easy making the wedge profile and associating apps
- Provides seamless profile switching with real-time checking of foreground app
- Massive deployment using PMDM or Scan2Stage

# Productivity

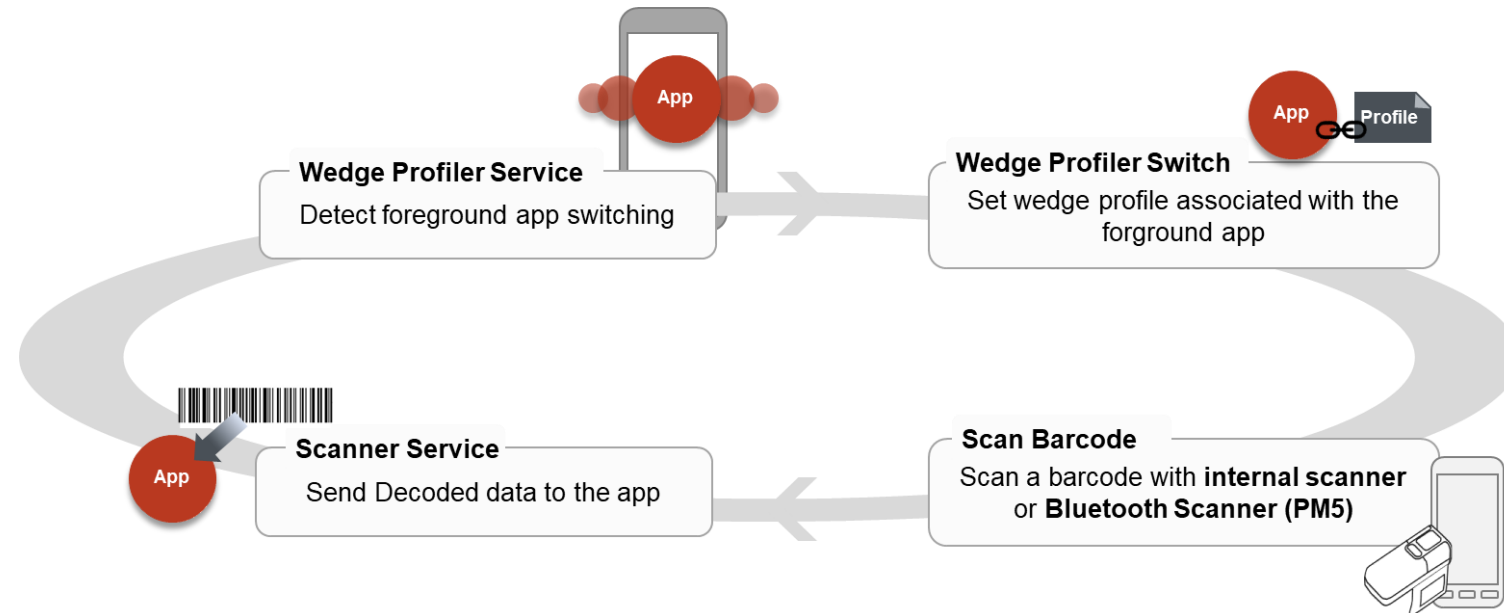

# For more detailed guide...

**Visit Knowledge Base > EmKit!**

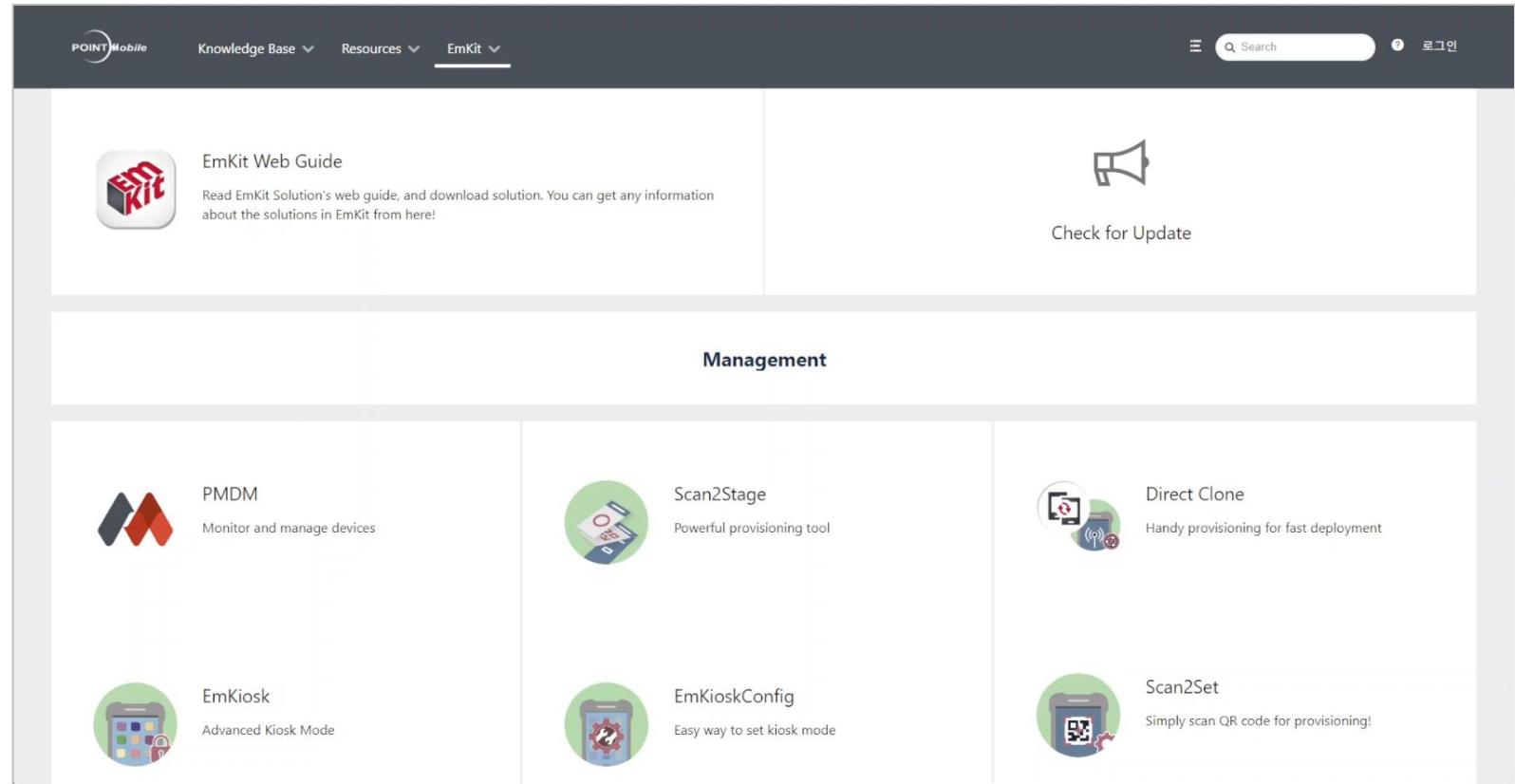

# Productivity



# Thank You

---

## Technical Architecture Team

If you have any further questions or looking for FAQ, please visit below link or do contact us.

[Knowledge Base Portal](#)

[pm\\_ta@pointmobile.com](mailto:pm_ta@pointmobile.com)